

# Assisted Living

at Edgewood Spring Creek  
Eagle



## The comforts of home, balanced with care

Edgewood's Assisted Living is a unique combination of housing, health care and comfortable amenities. Our approach offers a continuum of care with services customized for each individual's needs. Services and amenities include:

- On-site 24-hour staffing
- Scheduled consultation with our nursing services
- Coordination of transportation to appointments
- Three delicious meals per day plus snacks
- Housekeeping, laundry & linen services
- All basic utilities
- Emergency pendant system
- Daily life enrichment activities and regular outings

## Service Packages

To simplify pricing structures, we offer three service level packages. Services may include, but are not limited to medication management, assistance with dressing, bathing and grooming, assistance monitoring blood pressure, blood sugar, weight, and other daily vitals, and assistance getting to and from meals. Services are grouped based on number and type of services needed and/or acuity. The type of service level package is determined with a RN (or designee as determined per state regulations) who completes a total resident evaluation.

Level 1.....	\$675
Level 2.....	\$1,125
Level 3.....	\$1,925

## Apartment rates

---

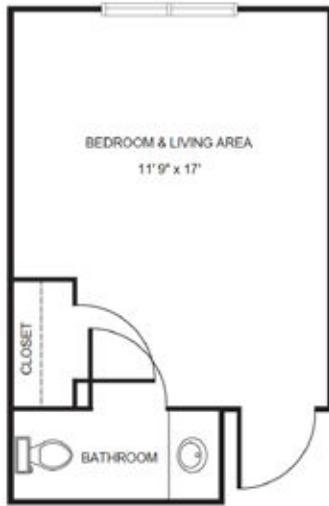

Studio starting at.....\$3,075



Large Studio starting at.....\$3,375

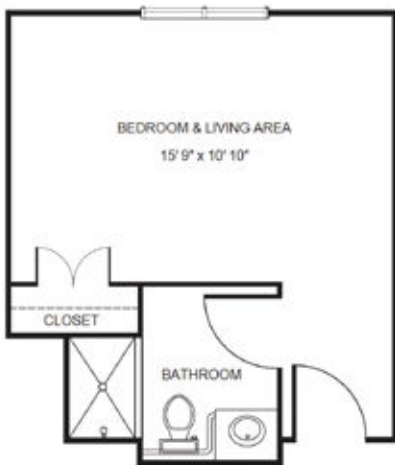

Deluxe Studio starting at.....\$3,600



One Bedroom starting at.....\$4,325

*\* Floorplans may vary*

## Additional rates

---

Community Service Fee (non-refundable) .....	\$1,500
Assisted Plus .....	\$200
Comfort Care Plus .....	\$200
Second Person Fee .....	\$1,100
Short Term Stay .....	starting at \$150/night